



Railway Neighbour

Contact and Communities
One Stratford Place
Montfichet Road
London
E20 1EJ

19 March 2019
Ref No: P2R / LTN1 / 5.21 / LP / CB

T 03457 11 41 41

Dear Neighbour,

Railway Upgrade Plan – Removal of temporary scaffolding bridge at Forest Gate Station

I am writing to inform you that Network Rail is required to undertake essential works near your property. I would like to sincerely apologise for the short notice given and for any disturbance that these works may cause you.

We will be removing the temporary scaffolding bridge at Forest Gate Station. Activities will commence this weekend, 23 & 24 March, when preparatory works will be carried out for removal of the footbridge, this will include the use of hand tools to remove lighting fixtures and electrical cables from the bridge during daytime hours between 08:00 – 18:00.

The main removal of the bridge will take place over the weekend of 29, 30, 31 March, finishing in the early hours of Monday 1 April. The removal of the bridge will involve the use of a crane and large lorries, which will be positioned at the junction of Forest Lane and Kuhn Way. As the loudest activity of the work is the dismantling of the scaffolding, the majority of this will be done off-site in an effort to minimise nuisance to the local community.

To make sure this work is done in a safe and efficient manner, Forest Lane and Kuhn Way will need to be closed to vehicles, pedestrians and parking in the area will be suspended. Access to this area will be closed from 00:30 Saturday 30 March and is planned to re-open at 04:00 Monday 1 of April*. Access to the shops on Forest Lane will be available at all times. Bus routes will be re-directed from this area. A map illustrating the details of the planned road closure can be seen overleaf.

*Please note there may be a situation where we go beyond these working hours, but this would **only** be in an emergency to ensure the site is left safe.

Time Table

Date of Work	Time of works	Work Activities
Sat 23 & Sun 24 of March	00:00 to 18:00	Decommissioning of the bridge services will commence with works undertaken during the daylight hours, however some minor preparation works will be undertaken at night. Hand tools will be used to prepare the structure for removal.
Sat 30 March - Mon 1 st April	00:00 to 04:00	The main work is planned to be undertaken continuously during these hours, but the noisiest works are planned for the daytime hours from 07:00 ongoing to Sunday 18:00, subject to unsafe weather conditions the works could be undertaken throughout the weekend closure period.

Road closures will commence from 00:30 Saturday 30th and will remain closed up until 04:00 Monday 1st April.

Work site set-up & break down, including the delivery of materials and other minor works which are less disruptive will take place outside of the hours listed above to make full use of the limited time available. You may experience some noise disruption from deliveries and vehicle movements during this time. At times, our work requires the use of Road Rail Vehicles. For safety reasons, these vehicles must sound a horn before every movement for the safety of our staff working on the ground

The nature of this work means some disturbance is unavoidable, but every effort is made to minimise unnecessary noise. Furthermore, those working on site are briefed before every shift on working responsibly within the local community.

I hope this information is helpful and we apologise in advance for any inconvenience these essential works may cause. If you have any additional questions or concerns please visit www.networkrail.co.uk/contactus or telephone our **24-Hour National Helpline on 03457 11 41 41.**

Yours faithfully



Paul Lennon
Community Relations Manager

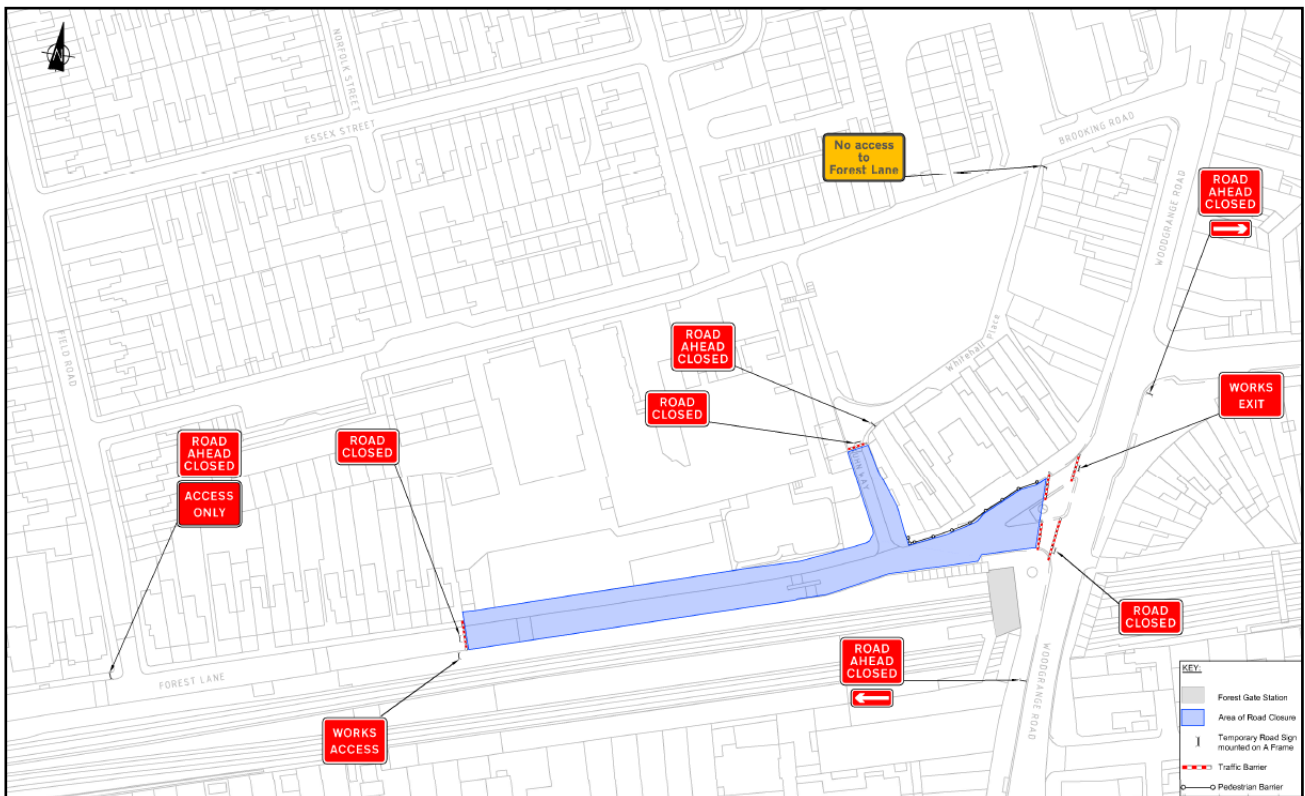

Map showing road areas which will be closed to the public during the removal of the bridge (00:30 Saturday 30th to 04:00 Monday 1st April)